

## Ceramic Piezo-Resistance Pressure Transmitter CS-PT1100B Series

±1~±4%F.S Accuracy

High stability, high reliability

Pressure sensor from Germany

Digital calibration

Packard Connector

Multiple pressure ports

Zero Point can be shifted freely

CE certification

RoHs standard

### Applications:

Compressor

Building water supply

Hydraulic control

Air conditioner

Automotive engine

Detection system

Hydraulic unit

Refrigeration equipment



### Introduction

CS-PT1100B series of pressure transducer feature high quality, high stability, small size, low weight, compact structure, low cost and mass production. The products are widely used to measure of air compressors, auto engines, air conditioning equipment, etc.

Stainless steel are ideal for industrial environment, pressure sensing elements are selected from well known international brands. The product is made of stainless steel and the pressure sensor is selected from well-known brands. Special circuits are adopted to adjust zero value and full range freely. The products have been approved with CE, intrinsically safe, and explosion-proof certificates.

Non-polar two-wire current output and three-wire voltage output are provided.

Products are produced according to military standards of advanced design, perfect technology, scientific management, strict production and quality control and have been sold to over 50 countries.

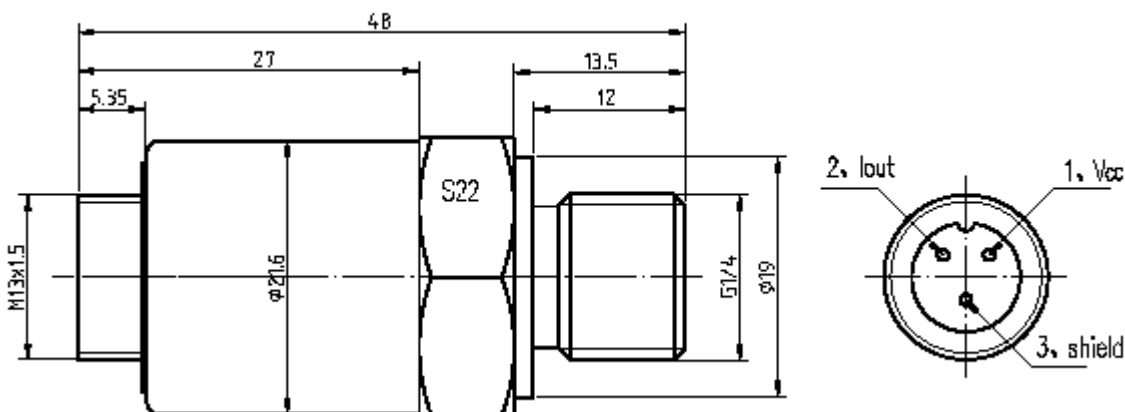

## Technical Parameters

Parameter	Value	
Measure Range	0-5bar...50bar	
Overload Pressure	1.5×RP(rated pressure)	
Broken Pressure	3×RP(rated pressure)	
Accuracy	±1, 2, 4%F.S (PT100&PT300series have higher accuracy)	
Stability	Typical 0.5%F.S , Max 1%F.S	
Operating Temperature	-40°C~120°C	
Compensation Temperature	-10°C~80°C	
Storage Temperature	-50°C~125°C	
Media Compatibility	corrosive medium compatible with Cr18Ni9Ti, ceramic	
Wires	Two-wire	Three-wire
Output Signal	4~20mA	0.5~4.5V
Power Supply	12~30Vdc	5Vdc/10~30Vdc/ac
load	(U-10)/0.02(Ω)	> 100KΩ
Insulation	> 100M Ω@50V	
Elec. connector	Aviation plugs	
Shell Protection	IP67	
Wire Protection	IP67	
Pressure Port	G1/4, NPT1/4, 7/16-20UNF	
Response Time	10ms	
Pressure Form	Gauge G	
Compliant	Intrinsic Safety E, RoHS, CE	
EMC	EMI:EN50081-1/-2: EMS: EN50082-2	