



SINOCERA



Global Sensor Technology

Piezoelectric Accelerometer (IEPE, Small Size)

Model: CA-YD-182

FEATURES

- Internal IEPE circuit
- Low output impedance
- Connection with standard cable
- Simple measurement system

SUPPLIED WITH

- Calibration chart
- M5 screw
- Protection cap
- STYV-1 cable fitted with L5 connectors (2M)

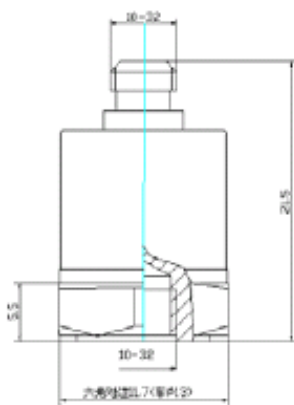

CHARACTERISTICS

Sensitivity (20±5°C)	1mV/ms-2
Max. Operational Range (±peak)	5,000 ms-2
Transverse Sensitivity	≤5 %
Frequency Range (±0.5dB)	1 to 10,000 Hz
Mounting Resonance Frequency	40,000 Hz
Operational Temp	Range -40 to +120 °C
Shock Limit (±peak)	3,000g
Operational Voltage	+18 to +28 V(DC)
Operational Constant Current	+2 to +10 mA (typical 2 mA)
Max. Output Amplitude (±peak)	≤8V
Noise (1 to 20kHz)	≤0.5 mg
Base Strain Sensitivity	0.2mg/με
Magnetic Sensitivity	1.5g/T
Thermal Transient Sensitivity	10mg/°C
Output Impedance	≤100 Ω
DC Bias	12±2 V

PHYSICAL CHARACTERISTICS

Weight	8 g
Case Material	Stainless steel
Mounting Method	M5 screw
Sensing Element	PZT-5
Output Connection	L5 (10-32 customized)

