



SINOCERA



## Variable Capacitance Accelerometer (DC to 400Hz)

Model: CA-DR-1001

### FEATURES

- Based on differential capacitance
- Wide frequency response
- Stable performance



### SUPPLIED WITH

- Calibration chart
- Four M2.5×20 bolts
- 3 core integral shielded cable (x2m)

### Technical Specifications:

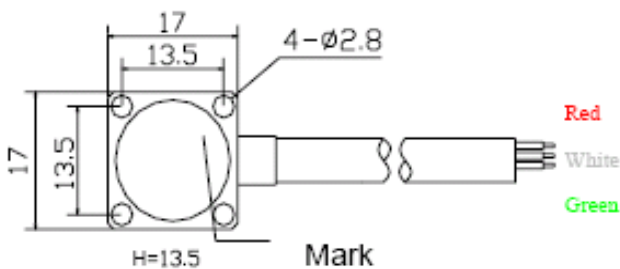

\*Wires :  
Red="+"; White=Ground;  
Green

Sensitivity (at 20°±5C )	100mV/m/s <sup>2</sup> ±10%
Measurement Range	±10 m/s <sup>2</sup>
Transverse sensitivity	≤5 %
Non-linearity	≤0.5%
Frequency Range	0 to 400 Hz
Mounted Resonance Frequency	5,000 Hz
Temperature Range	-40 to +85 °C
Temperature Sensitivity	0.1 mV/°C
Shock limit (No Supply)	±5000 m/s <sup>2</sup>
Power Supply	+6 to +16 VDC
Operating Current	≤3mA
Offset Voltage	2.5±0.1VDC
Noise(100Hz)	< 2.25mVrms
Output impedance	< 100 Ω
Weight	20 g
Case material	Stainless Steel
Mounting	4-Φ2.8 hole
Output Cable	2m Length with 3-core: Red: Power Supply ; White: Ground; Green: Signal Output

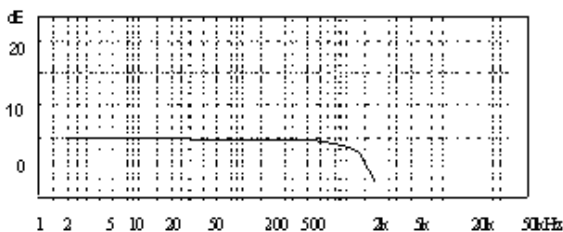
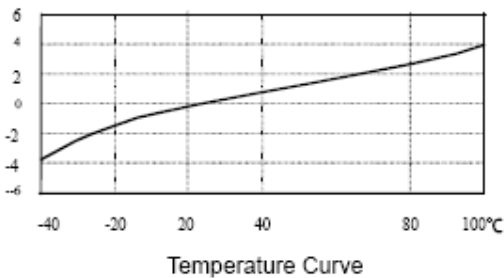

### Accessories

Calibration chart	1
M2.5×20 Screws	4